

# zCharger-DVR

Hidden Cam Wiress charger



MANUAL

# Getting to Know the zCharger

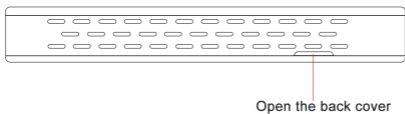
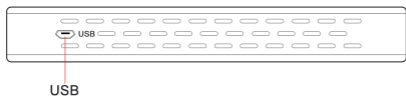
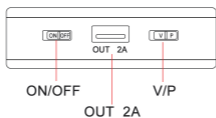
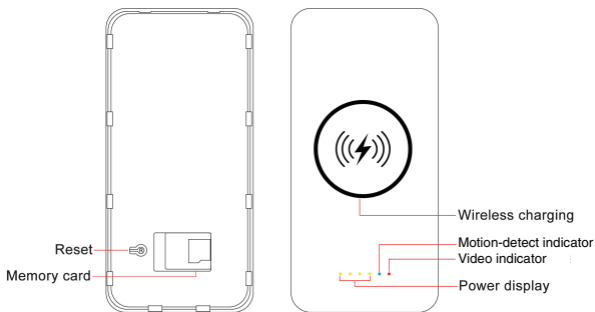
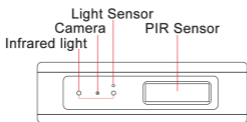

# Operating instructions

The **yellow light** indicates battery power status (it will be on 10 seconds when the camera is powered on/off and switched in different modes)

The **red light** indicates video recording mode the blue light indicates motion detection mode.

## (1) Operation Modes

The two modes are "**V**" for continuous video recording mode and "**P**" for motion detect video recording mode.

Slide the V|P key to V position for continuous video recording mode.

Slide the V|P key to P position for in video recording mode

## (2) Switch ON/OFF

Slide the ON/FF key to On position, the camera starts recording; Slide the ON/FF key to OFF position, the camera turns off and saves the recorded files. Please choose the mode to record in before turning the power on.

## (3) Continuous video recording and storage

In the continuous recording mode (mode key is in V), the switch key slides to the ON position, the red light will blink three times and go off to start recording. At the same time, the yellow power indicator will be on.

After 10 seconds, the yellow power indicator will go off. Slide the switch key to OFF position, the red and blue lights blink three times at the same time, then turn off, save the video and powering down.

## (4) Motion-activated recording and storage

In "P" mode (the V|P key is set to P), when the ON/OFF key is turned to the ON position, the blue light will blink three times and go off to enter the motion detect mode. At the same time, the yellow power indicator light will be on for seconds, then will go off. When motion is triggered, the video recording will automatically start and one new file will be saved every minute. If no motion is triggered the system will enter the low-power standby mode, and there will be no indicator light under "P" status.

Slide the switch key to OFF position, the red and blue will blink three times at the same time and then turn off. Video is saved and camera turns off.

## (5) Auto mode switch

The camera supports the automatic switching of V (continuous video recording mode) and P (motion detection video recording mode / low power consumption mode), the yellow light will be on for 10 seconds each time to display the remaining battery power when you switch the mode.

## (6) Charging

**Charging the charger:** Connect an A/C-to-USB adapter to the wireless charger camera device using the included micro USB data cable. You can also charge it by connecting it to a computer's USB port.

The yellow light will blink in sequence. After the battery is fully charged, all the 4 yellow lights will be on solid.

**Charging your phone:** Set the ON/OFF switch to the ON position then place a smart phone with wireless charging support centered on the charging device, your phone will indicate when its charging.

## (7) SD Memory Card

To access the memory card slot, find the gap on the side of the device and use your finger nail to pull the cover off. Insert a Micro SD memory card by sliding it from the left as seen in the image below, it should latch into place.

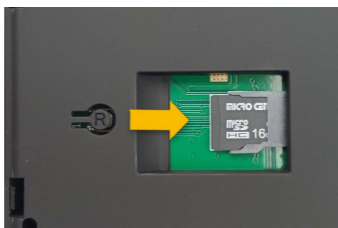
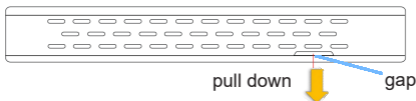

## (8) File storage and media playback

Please pull out SD card from the device and connect it to computer using an SD card adapter or SD card USB reader to play the recorded video files.

We recommend VLC media player to playback videos recorded with this device. You can download it for free at <http://videolan.org>

## (9) Video Date/time stamp

To change or update the video time stamp please download install the zUtility app from the URL below. Choose the **zCharger** from the main menu and follow the steps in the app.

<https://www.zetronix.com/download>



# Troubleshooting

Resetting the device can clear up any issues when the device is not responding correctly.

To reset, open the bottom cover, press and hold the reset switch for 10-15 seconds.

Most issues are likely due to memory storage, if you run into issues, check that the memory is not full, and please try formatting the memory card using your computer as this will clear up any corruption in memory that could be causing issues. **Note** formatting the memory card will wipe all recorded media.

## Notice

- Please consider local laws in regards to operating a hidden camera before using this device.
- To avoid damaging the camera lens, please do not point the lens directly to sunlight.



**Scan this QR code to download  
a PDF version of this manual.**