



100% Wire-Free:
Free Of Ugly cords
and wiring hassles



Night Vision: See what's
happening even in the dark



HD Quality: Enjoy
amazingly sharp
1080P live video



Wi-Fi: 802.11 b/g/n wireless
network



**Micro SD :Memory
Card max up to 128GB
(Not included),
8GB 400 days videos**



Motion Alerts: Receive push
notifications if anything moves



Built-in 6000mA battery:
Battery supports to
standby 6-8 months



Fast Response: 1 second enable
recording even at standby mode



Low Power Consumption:
200uA at standby mode

1.Product Structure

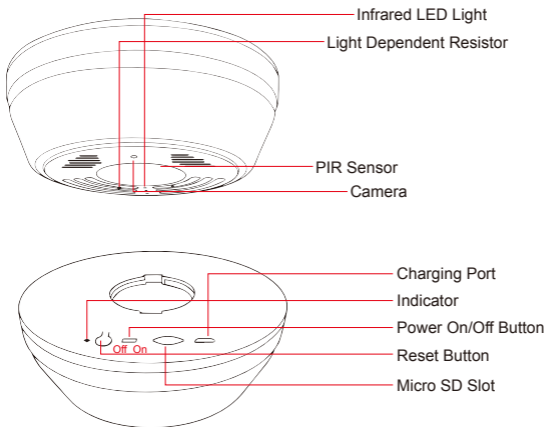

2.Package Content



Main Device



User Manual



Screw



USB Cable

3. Installation



9.8ft(300cm)

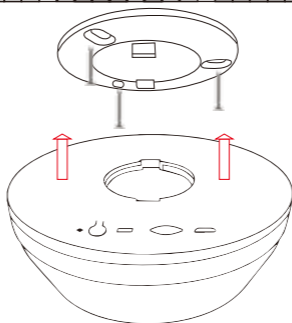

6.5ft(200cm)

9.8ft
(300cm)

3.2ft
(100cm)

6.5ft
(200cm)

13.1ft
(400cm)

16.4ft
(500cm)

3.2ft(100cm)



4.Specification

Camera	
Built-in image sensor	1/3" progressive CMOS sensor
Sensor sensitivity	1.0 Lux
Focal Length	0.6 mm or 2.8mm(For Selected Model)
Angle of View	60° or 128° (For Selected Model)
Video Spec	
Algorithm	H.264, JPEG
File Format	AVI,JPEG
Video recording mode	PIR motion recording mode
Recording capability	1920x1080P
Frame rate	Up to 15 fps
Night vision	Up to 5 meters (16.4ft)
PIR detect distance	5 meters (16.4ft)
PIR boots up	In 1 seconds
Video file length	10-60 seconds option
Audio	
Microphone	Disabled
Speaker	Not available
WiFi Spec	
WIFI	Built-in WiFi Module(IEEE 802.11b/g/n)
Storage	
Memory type	Micro SD Card (Support SDHC max=128GB,not included)
Misc	
Date/Time Table	YYYY/MM/DD, HH:MM:SS
Snapshot	Recording
Power	
Power	Input DC 5V
Power Consumption	200uA in standby,190mA-220mA in recording(WiFi), 590mA-650ma mA WiFi +Night vision
Charging Time	24 hours(5V 2A)
Battery Input	DC 3.7V/6000 mA high polymers battery
Battery Lifetime	6-8 months in PIR standby

Recording time	400 days@1280*720p (8GB micro SD card not included),base on 10 detecting files per day
Push alarm notification	Motion detected alarm,Low battery
Product Dimension	12.8*10*4.6cm(5x3.9x1.8INCH)
Others	
App name	Yiye
Mobile surveillance	iPhone, Android
Remote access	Yes
View Angle	Bottom or Side view
Indoor/outdoor usage	Indoor

5.Charging the battery

This unit has a built-in rechargeable lithium battery. When using the unit for the first time,please charge it 24 hours. Open the device (Picture#1),make the USB power cable connected with charger seat and insert the charger into the electrical outlet (Picture #2). The Green LED indicator will be blinking slowly,until charge 24 hours fully.

(Note:There is no LED indicator displayed during charging for the first 20 minutes when battery is ran out completely.)

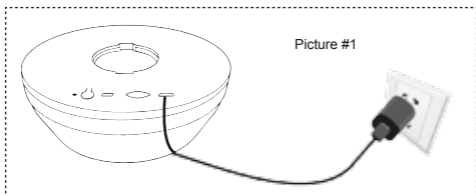

6.Format Memory Card

There are two ways to format the memory card.

- 1).Format the card on computer.
- 2).Insert micro SD card into memory card slot. Go to Yi eye app to format. More information ,please refer to **9.5 Playback&Share Videos and Photos** in user manual.

7.LED Light State Introduction

No.	LED Status	Device Status
1	Slowly blinking green	Charging power for battery
2	Slowly blinking red within 180 seconds	Power on device ,to be connecting to WiFi
3	Fast blinking green 11 times, change to solid green 10 seconds	Power on device ,WiFi connected
4	Fast blinking red 5 times	Device power off
5	Solid green	Device abnormal, press and hold the Reset button for 30 seconds, then release

8.Preparation

This device can support remote viewing on both IOS and Android devices.

- 1).IOS:Log-in to the Apple "APP store" and search for "Yieye".
- 2).Android:log-in to Google "Play store" and search for "Yieye".

You may also scan the QR code below that corresponds to your mobile operating system to download and install app.



Apple store: Yieye



Google Play: Yieye

YOU NEED TO KNOW BEFORE SETUP:

1. Make sure you are using 2.4GHz wireless network, not 5GHz
2. Make sure the RED LED light is blinking slowly when power on. if not, please reset the camera.
3. Make sure your camera and wifi router are not far away.

4. Make sure your phone is close to the camera when configuring.
5. Go to Wi-Fi setting of your smartphone to see if camera ID like YIEYE-XXXXXX-XXXXXX is matched with the one we put the sticker on the device
6. Make sure your Wi-Fi SSID do not contain any symbol or special characters.
7. Make sure your camera is charged up to 30 hours for the first time use.

9.Start using the device Wi-Fi Configuration

Step 1 Place the dummy smoke detector security camera on a flat surface close to home router along with user's mobile phone, slide the ON/OFF switch to On position. Red LED blinks within 180 seconds.

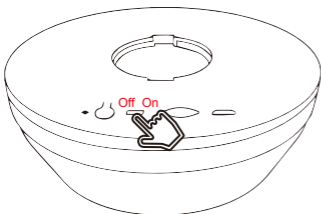
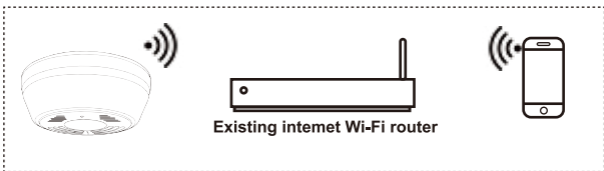

Note:It only support 2.4Ghz internet Wi-Fi network,no 5G network.

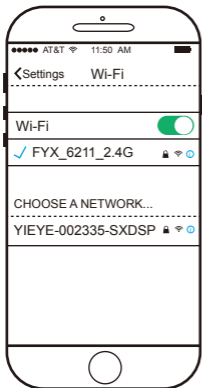

Step 2 Wait a full 40 seconds for the device to boot up, then enter Setting on the phone, select Wi-Fi, scan and join the network of Wi-Fi router.

Note:

- A. Please do not directly connect and join camera ID in Wi-Fi setting of your smartphone
- B. If there is no camera ID like YIEYE-XXXXXX-XXXXXX displayed, Press and hold Reset button up to 10 seconds and then release to reset the camera.

i WARNING

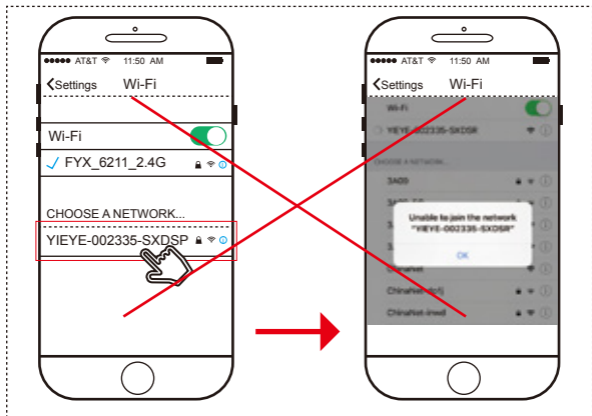

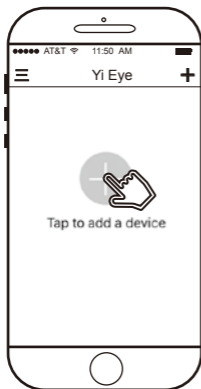

Step 3 Open the Yi eye APP on the phone, and click Tap to add a device.

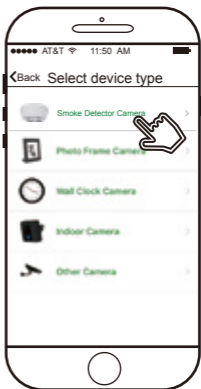

Step 4 Tap on Smoke Detector Camera as shown.



Step 5 Tap on Red LED is blinking slowly.

Notice: Make sure you see Red LED is blinking slowly before clicking the button of Red led is blinking, If not, please reset device!

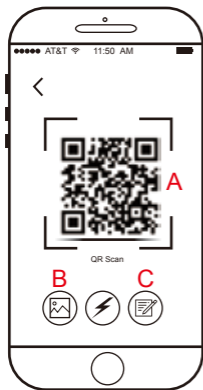

Step 6 Select method A,B,or C to add device.

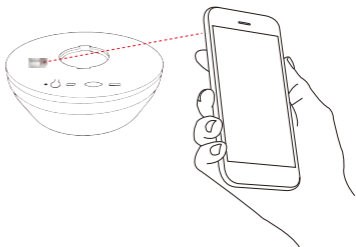

A:Scan the QR code on your device,this is the quickest way to add the camera.



B:Press the icon  on the lower left corner ,add the picture of QR code in your phone's photos.

C.

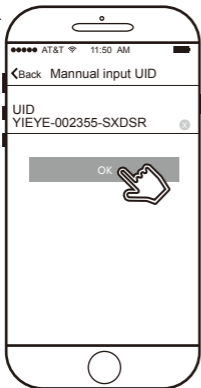

Press the pencil icon  on the lower right corner, and enter camera ID on your device as shown.

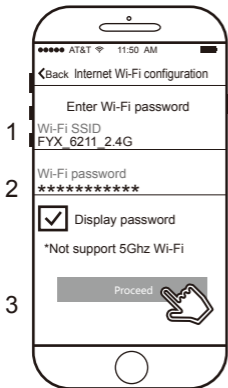

Step 7

Enter the home owner's SSID and password, then press Proceed.

Notice: It do not support 5Ghz wireless network, Only 2.4Ghz wireless network!

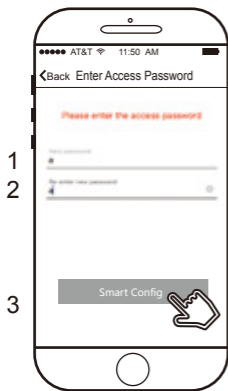

Step 8

Enter owner's access password and keep in mind in case, then tap on Smart Config.

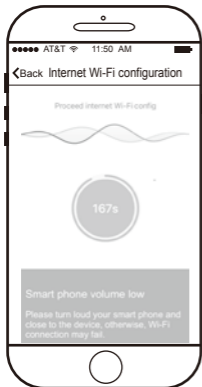

Step 9

Wait for 3 minutes, the configuration will be done.

Note:

- A. Please put your smart phone to the device within 10CM.
- B. Turn the volume of smart-phone to maximum.
- C. If configuration failed:
 - Please make sure enter correct Wi-Fi password (Note: case-sensitive and blank).
 - Keep the environment is quiet when do the configuration.

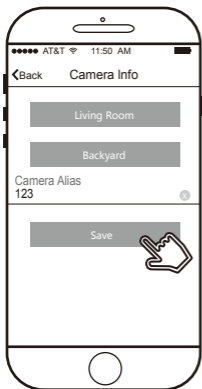

Step 10

Name the device, tap on Save.

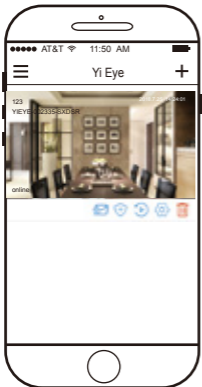

Step 11

The dummy smoke detector camera should be online as shown.

9.1 Watch Live Video

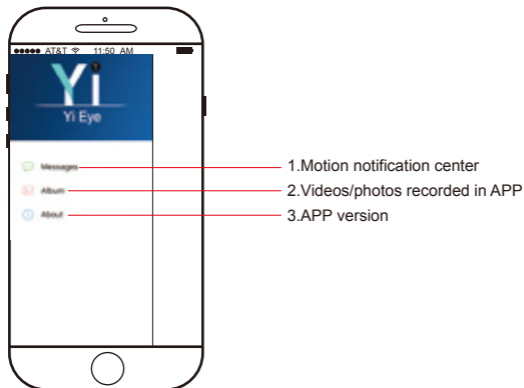
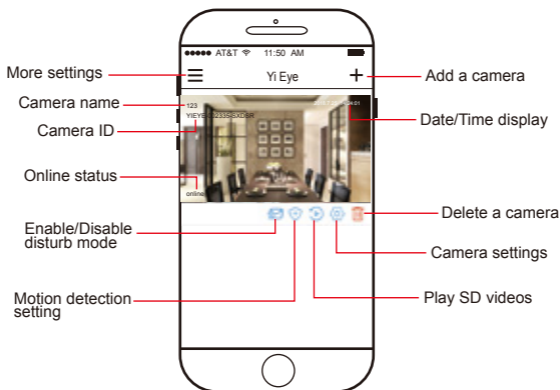

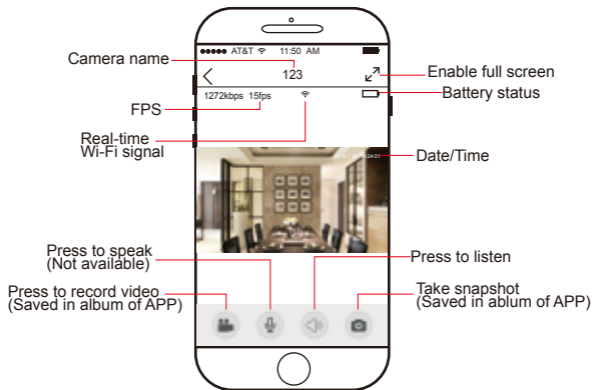

9.2 Add Online Devices

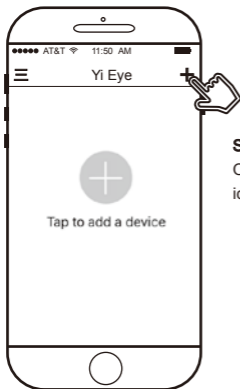

Step 1

Open the Yi eye APP on the phone, and click **+** icon on the top right corner.

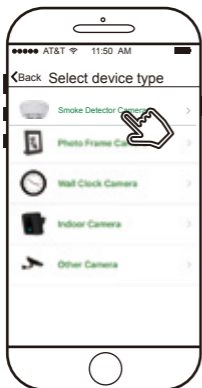

Step 2 Tap on Smoke Detector Camera as shown.



Step 3 Tap on Add online devices.

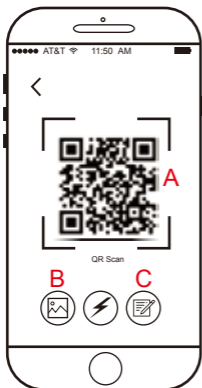

Step 4

Select method A,B, or C to add online device, more information, please follow **Step 6** above.



Step 5

Enter correct camera's password,
select Save.



Step 6

Wait few seconds as shown.

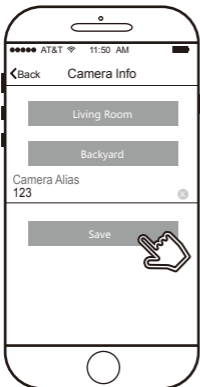

Step 7

Name the device ,tap on Save .The device will
be online.

9.3 Motion Detection Setting

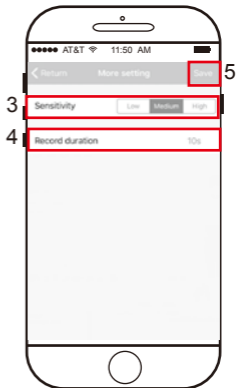
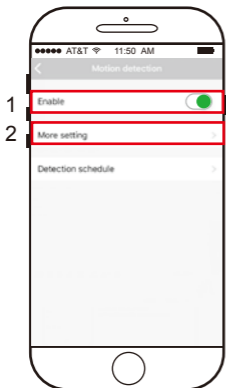

Enable motion record

1. Slide Enable to On position

2. Tap on More setting

3. Select Sensitivity(Low/Medium/High)

4. Select video file length of motion record(10-60 seconds selectable,
10 seconds defaulted)

5. Press Save and back to the live view mode

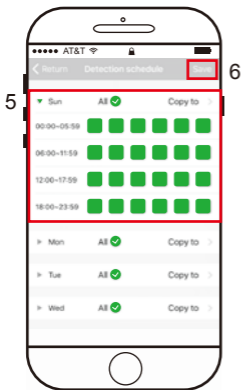
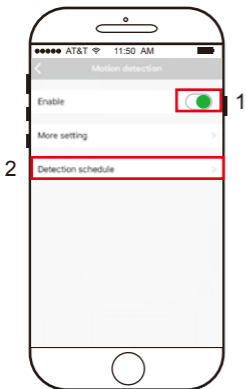

Enable schedule motion record

1. Slide Enable to On position
2. Select Detection schedule setting
3. Select All with check mark icon ✓ to setup full time motion alarm
4. Tap Days icon to select which day to setup alarm (Through Monday to Sunday, multiple selection available)
5. Select time period for schedule record
6. Press Save



Disable schedule motion record

1. Unmark All with the check icon ✓
2. Press Save on the upper right corner and back to live view mode

9.4 Alarm Setting

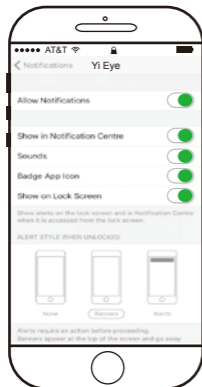

Step 1

Enable Notifications on the phone as shown



Step 2

Enable motion detection as shown.

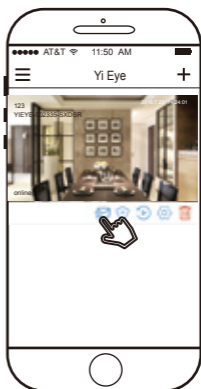

Step 3

Disable disturb mode.



Step 4

The phone will receive notification message as shown once motion is detected.

9.5 Playback&Share Videos and Photos

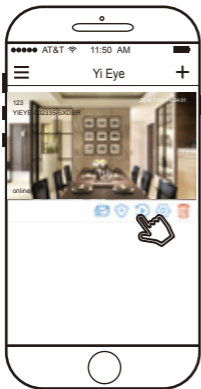

Enter into SD card playback menu as shown.

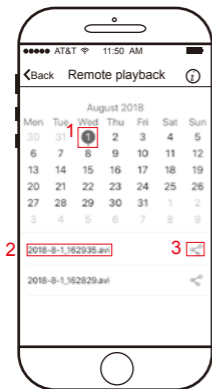

1. Choose date
2. Tap to play video
3. Share video to friends and family members as shown.

Memory Card information

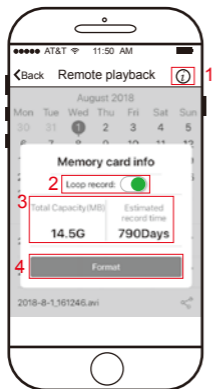

1. Memory card info menu
2. Enable/disable loop recording
3. SD card information
4. Proceed format SD card

Share Photos

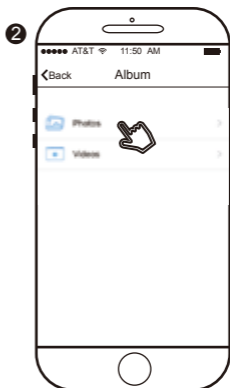
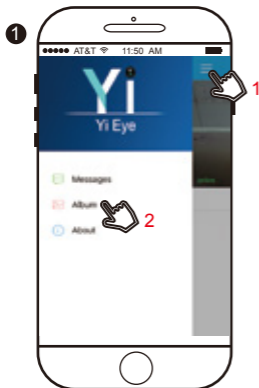

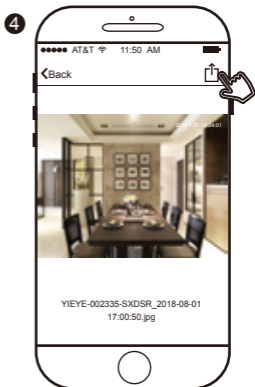
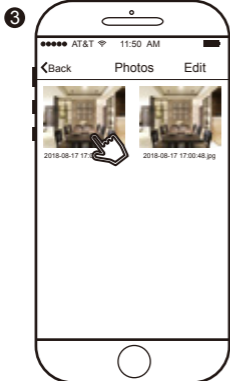

Share your favorite picture to friends and family members as shown.

Share Videos

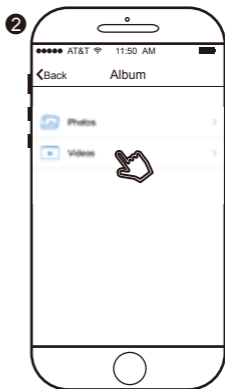



Share your favorite video to friends and family members as shown.

9.6 Change Device Code



Go to Settings in APP ,and tap on Access code, then enter the information asked(Old/New code/ Re-enter new code),and press Save.

9.7 Reset

Dummy smoke detector camera can be reset in the following ways:

- 1). Press and hold the reset the button for 10 seconds to reset WiFi video camera and restore the factory settings after power on device.

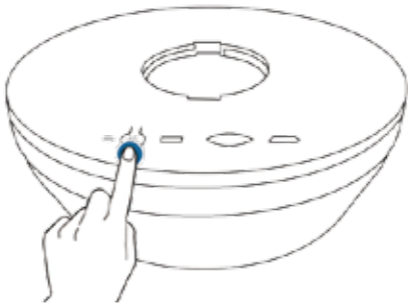

- 2). Go to Settings in APP, and tap on Restore to factory setting, then click as shown.

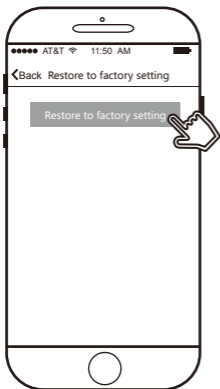

Note: Please wait up to 2 minutes after reset!

9.8 Change the IP connection from A internet to B internet

Default the device as point 9.7, then follow point 9 to configure internet Wi-Fi.

9.9 Other Options

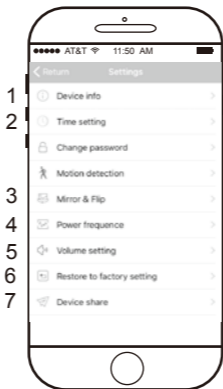

1. Change camera name as your demand and update the latest firmware to the camera when available.
2. Setup correct time and date stamping
3. Change the image display direction.
4. Enter correct power frequency
5. Adjust speaker and microphone volume (Speaker not available, audio disabled)
6. Restore the camera to factory default setting
7. Share Camera ID to friends and family members