



**WhatsGPS**

# **GPS Positioning Terminal**

Model: TinyTrack-26L



**Manual**

## 1.Product Features



Real-time  
Tracking



4G network  
communication



Multiple positioning  
BDS+GPS+LBS+AGPS



OTA remote  
upgrade



Easy to  
install



High capacity  
rechargeable battery



Two-way  
conversation



Light pet  
search



Sound  
pet search



Blind spot  
supplementary  
transmission



Power - off  
alarm



Geo-fencing  
alarm

## 2. Installation Instructions

### 2.1. Appearance

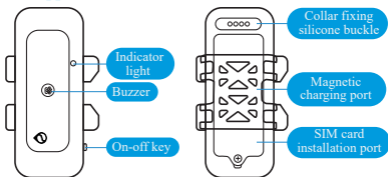

### 2.2. Device online operation

**2.2.1.** Insert the SIM card into the GPS tracker (SIM card requires SMS, data service and phone function)

Turn on the button of the GPS tracker and make sure the light is on.

(Make sure the device has power, if not, connect it to the vehicle's battery, the battery will power it)

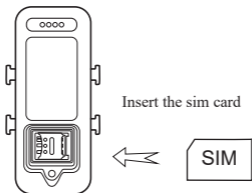

### 2.1.2. Command send operation

Please send two text messages to sim card number of GPS tracker using your mobile phone.

#### 1) [APN,123456,apns'name](#)

This SMS is used to connect the GPS tracker to your local network.

(apns'name. is the APN of your SIM card's local carrier,such as [APN,123456,cmnet](#)

If you don't know the APN of your sim card, check it by searching or ask your local carrier)

#### 2) [IP gps.whatsgps.com 6802](#)

This SMS is used to connect GPS tracker to WhatsGPS tracking platform

For other platforms, please refer to this format to send commands, see the command list below for details

2.1.3 To see whether the tracker is online, go to

[www.whatsgps.com](http://www.whatsgps.com) or download the WhatsGPS app.

## 2.3 LED status

LED type	LED status	Meaning
Blue	Slow flash	Searching for satellite signals
	Always on	GPS/BDS has been located
	Not bright	GPS/BDS sleep
Yellow	Slow flash	Communication network initialization
	Always on	Network communication is normal
	Not bright	Network Sleep/Shutdown
Red	Always on	connected to power/charging
	Not bright	be filled

## 3. Installation diagram

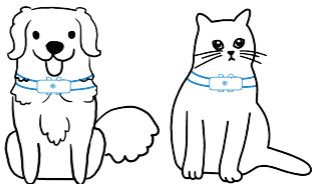

## 4.Specifications

Project	Specification	Remark
Operating voltage	3.7V	
Position method	GPS+BDS+LBS+AGPS	
Positioning error	<10 M	
Communications network	2G/4G	
Communication band	Asia version: LTE-FDD B1/B3/B5/B8 LTE-TDD B34/B38/B39/B40/B41 GSM 900/1800 MHz Euro version: LTE-FDD B1/B3/B5/B7/B8/B20 GSM 900/1800 MHz Latin version: LTE-FDD B1/B2/B3/B4/B5/B7/B8/B28/B6 6 GSM 850/900/1800/1900 MHz	
Communication mode	TCP	
Range of working temperature	-20°C~ +75°C	
Working humidity	10%-85% RH	
Specifications size	L75.8mm*W37.6mm*H19mm	
Weight	42g	
Built-in battery capacity	700mAh	
Standby time	*4 days	
Warranty period	1 year	

\*The power consumption of the device is related to the daily exercise of the pet. The battery life of 4 days is calculated according to the normal situation of walking the dog for 2-3 kilometers per day (the power consumption will be accelerated when the signal condition is particularly poor, if you encounter such problems, you can contact customer service for consultation and resolution)

## 5. Description of Common Commands

The following commands can be sent by SIM card SMS or WhatsGPS platform

### 5.1 Common setup commands

SN	Command function	Command format	Remark
1	Set online	IP gps.whatsgps.com 6802	Set the device to point to server IP and port
2	Set APN	APN,123456,apnname	The APN varies according to the local telecom operator
3	Heartbeat interval setting	interval,123456,T1	T1: 60-360S, defaults to 60s
4	Set time zone	zone,123456,e08	E/W, for the eastern and western time zones;; E08: Indicates the East Eighth District



## 5.2.Common query commands

SN	Command function	Command format	Remark
1	Query Network	CXWL	Query the network of the device
2	Query statu status	CXZT	Query the current working status of the device
3	Device restart	CQ	

## 5.3.Common alarm commands

SN	Command function	Command format	Remark
1	Low battery alarm	LOWBATLM, 123456,N	Battery low voltage alarm; 0 off (default) N=20 means 20% of battery power, range 1%-99%

## 5.4.Common control commands

SN	Command function	Command format	Remark
1	Alarm sound switch	soudswitch,123 456,[A]	A=1 alarm sound on A=0 alarm sound off
2	Pet-seeking alarm light switch	ledswitch,12345 6,[A]	A=1 alarm light on A=0 alarm light off

## 6. Troubleshooting

If you feel something is wrong with your device while operating, see the following questions and solutions. If the problem still cannot be solved, please contact the seller or service provider.

Common Problem	Cause	Solution
Poor signal reception	When devices are used in areas with poor reception, such as near tall buildings or basements, radio waves cannot be transmitted effectively	Use the device in a location with good signal
Unable to connect to the network	The SIM card is not installed properly	Check the SIM card
	Dirt on the metal surface of the SIM card	Wipe with a clean cloth
	Invalid SIM card	Contact your Internet Service Provider
	Out of GSM service area	Please move to ISP service area
	Weak signal	Please move to a strong signal and try again
Shutdown	Please confirm whether the device is switched on	Turn on the device battery switch
	Please check whether the SIM is installed properly	Please install the SIM card properly
	Poor contact	Check that the plug is properly connected

## 7. After-sales warranty card

### User information

User name		Contact number	
Address			
Product model		IMEI number	
Date of purchase		Invoice number	
Name of the seller			
Seller's address			
Seller's phone number			

\* This card is the basic warranty certificate, please fill it carefully and keep it properly.

### Warranty Description

Important Note: Please keep this warranty card properly, and enjoy one-year after-sales warranty with this card. If this card is lost, your terminal warranty period will be postponed to your purchase date within 30 days after the factory date of the terminal checked by our company.

Second, the scope of the warranty.

- 1: During the warranty period, we give free warranty if there is a problem due to the quality of the repair item itself.
- 2: During the warranty period, such as due to human factors, improper operation, incorrect power supply voltage caused by failure, due to the courier process dropped, damaged by their own disassembly or torn warranty strip, and natural disasters are not covered by the warranty.
3. This warranty does not apply to cases other than defects in materials, design and workmanship.
4. There is no right to extend or renew the warranty for repair or replacement under this warranty.

## 8.Platform tracking

### Installation video

You can watch the installation video of the device and the tutorial video of using the APP on YouTube by scanning the QR code below

